

Courses & distances
up Buffalo Creek

| | | | |
|---|----|---|------------|
| N | 49 | W | 25 |
| S | 76 | W | 100 |
| S | 6 | W | 20 |
| N | 71 | W | 83 |
| N | 16 | E | 65 |
| N | 32 | W | 66 |
| | | | <u>359</u> |

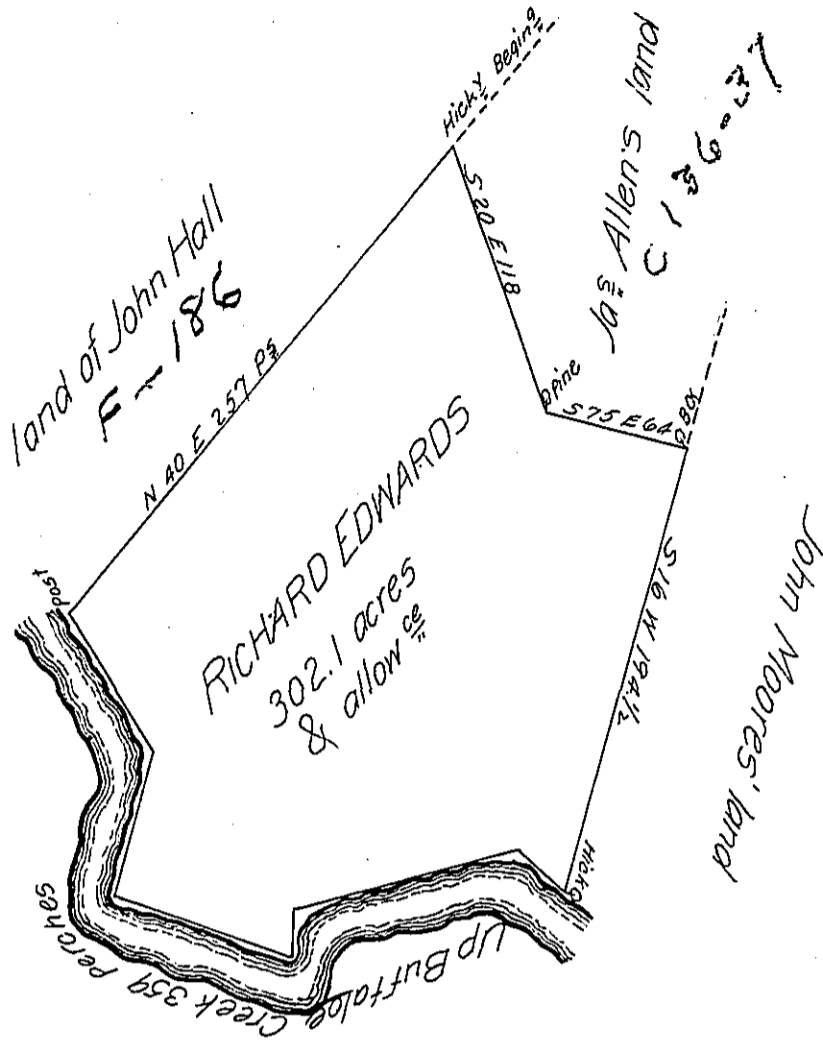

The Draught of a Tract of land Called _____ Situate on the North side of Buffalo Creek in the County of Berks Containing Three hundred two 18 perches with the usual allowance of Six Acres P Cent for Roads Survey'd the 12th day of August Anno Dom 1769 In Pursuance of an Order of Survey to Richard Edwards bearing date at Philadelphia the 3^d day of April Anno Dom 1769. No 714

To John Lukens Esq: S.G.

Sign'd

P. W. Maclay D.S.

IN TESTIMONY that the above is a copy of the original remaining on file in the Department of Internal Affairs of Pennsylvania, made conformably to an Act of Assembly approved the 16th day of February, 1833, I have hereunto set my Hand and caused the Seal of said Department to be affixed at Harrisburg, this sixth day of March 1906

John R. Brown
Secretary of Internal Affairs.